

X43W-10 旋塞阀

X43W-10 Cock valve

用途：本产品适用于工作温度 $\leq 100^{\circ}\text{C}$ 的油品、煤气等介质的管路上，作启闭用。

Usage: Turn on turn off the pipelines where the medium, (such as oil products, coal gas etc) working temperature is less than 100°C .

主要零件材料 Main parts and materials

零件名称	Name of parts	材料	Materials
阀体	Body	HT200	
旋塞	Cock	HT200	
压盖	Gland	HT200	



性能规范 Function and specification

型号	公称压力	试验压力		工作温度	适用介质
		强度(水)	密封(水)		
Type	Nominal pressure (MPa)	Strength (Water) (MPa)	Enclose (Water) (MPa)	Working temperature ($^{\circ}\text{C}$)	Suitable medium
X43W-10	1.0	1.5	1.1	≤ 100	油品、煤气 Oil, Coalgas

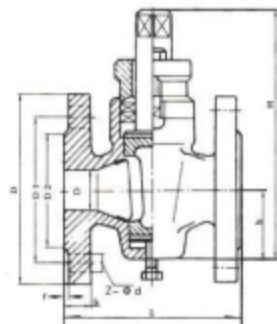

外型尺寸和连接尺寸 Outling and connect measurement

型号	公称通径	尺寸						
		L	D	D ₁	D ₂	$z - \phi d$	b	H
Type	Nominal ϕ DN(mm)							
X43W-10	25	110	100	85	65	4-14	16	133
	32	130	130	100	78	4-18	18	152
	40	150	145	110	85	4-18	18	212
	50	170	160	125	100	4-18	20	260
	65	220	180	145	120	4-18	20	295
	80	250	195	160	135	4-18	22	327
	100	300	215	180	155	8-18	24	425
	125	350	240	210	185	8-18	24	482
150	350	280	240	210	8-23	24	512	