

## DIN 2566 THREADED

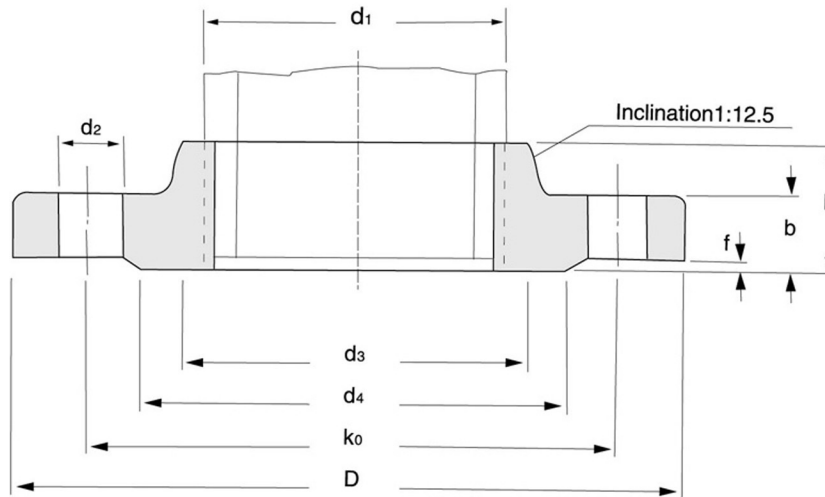

PIPE		FLANGE						NECK	RaisedFACE	BOLT				Approx Weight (kg)	
DN		d <sub>1</sub>	Tthread according to DIN 2999	D	b	k	h	d <sub>2</sub>	d <sub>4</sub>	f	NO	BOLT	d <sub>2</sub>		
mm	inches														
15	1/2 "	22	R1/2 "	95	14	65	20	35	45	2	4	M12	(1/2 ")	14	0.61
20	3/4 "	27.6	R3/4 "	105	16	75	24	45	58	2	4	M12	(1/2 ")	14	0.91
25	1 "	34.4	R1 "	115	16	85	24	52	68	2	4	M12	(1/2 ")	14	1.10
32	1 1/4 "	43.1	R1 1/4 "	140	16	100	26	60	78	2	4	M16	(5/8 ")	18	1.60
40	1 1/2 "	49	R1 1/2 "	150	16	110	26	70	88	3	4	M16	(5/8 ")	18	1.76
50	2 "	61.1	R2 "	165	18	125	28	85	102	3	4	M16	(5/8 ")	18	2.34
65	2 1/2 "	77.1	R1 2/2 "	185	18	145	32	105	122	3	4	M16	(5/8 ")	18	3.18
80	3 "	90.3	R3 "	200	20	160	34	118	138	3	8	M16	(5/8 ")	18	4.12
100	4 "	115.9	R4 "	220	20	180	38	140	158	3	8	M16	(5/8 ")	18	4.47
125	5 "	141.6	R5 "	250	22	210	40	168	188	3	8	M16	(5/8 ")	18	6.13
150	6 "	170.5	R6 "	285	22	240	44	195	212	3	8	M20	(3/4 ")	22	7.92

Material specifications according to RSt37.2(DIN 17100)

Tthread according to DIN 2999(ISO7.1)

Marked on the edge: Brand; DIN 2566; DN/d<sub>1</sub>; Material: PN; heat n "