

BS 4504 PN10

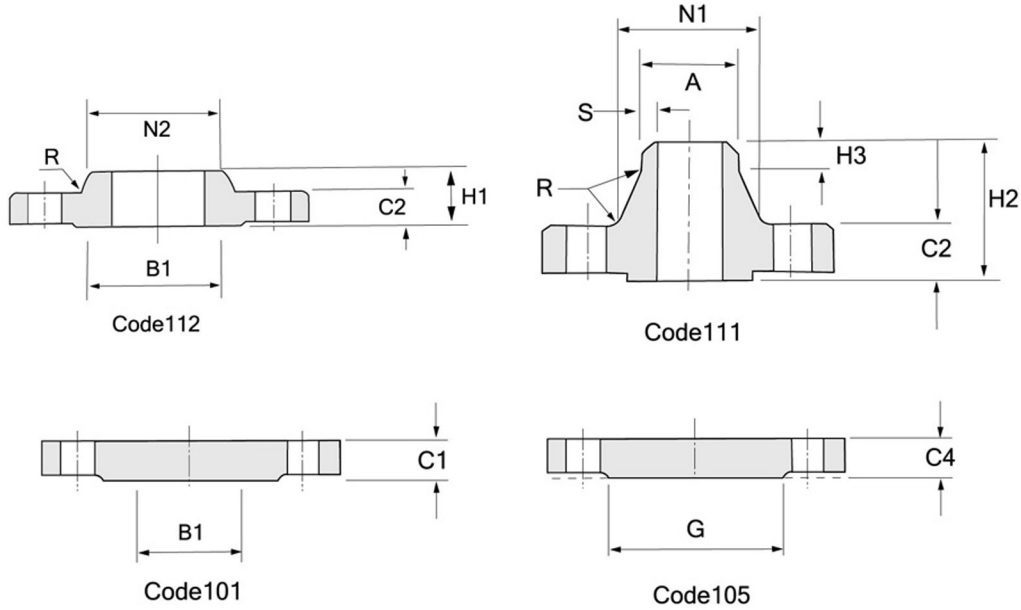

Unit:mm

| Nominal size DN | Mating dimensions | | | | | Outside diameter of neck A | Bore diameters B1 | Flange thickness | | | Diameter of shoulder G | Langths | | | Neck diameters | | Radius R | Neck thickness S |
|---|--------------------------|---------------------------|-------------------------|---------|------|----------------------------|-------------------|------------------|-------------------|-----|------------------------|------------|-------------------|-------------------|-------------------|-----|----------|------------------|
| | Outside diameter D | Diameter of bolt circle K | Diameter of bolt hole L | Bolting | | | | C1 | C2 | C4 | | H1 | H2 | H3 | N1 | N2 | | |
| | | | | Number | Size | | | | | | | | | | | | | |
| Codes affect.ed | 101, 105, 111, 112, 113, | | | | | 111 | 101 112 | 101 | 111 112 113 | 105 | 105 | 112 113 | 111 111 111 | 111 112 113 | 111 112 113 | 111 | 111 | |
| 10 15 20 25 32 40 50 65 80 100 125 150 | Use PN dimensions | | | | | | | | | | | | | | | | | |
| 200 | mm | mm | mm | mm | mm | mm | mm | mm | mm | mm | mm | mm | mm | mm | mm | mm | mm | |
| 250 | 340 | 295 | 22 | 8 | M20 | 219.1 | 221.5 | 24 | 24 | 24 | 190 | 44 | 62 | 16 | 234 | 246 | 8 | 5.6 |
| 300 | 395 | 350 | 22 | 12 | M20 | 273.0 | 276.5 | 26 | 26 | 26 | 235 | 46 | 68 | 16 | 288 | 298 | 10 | 6.3 |
| 350 | 445 | 400 | 22 | 12 | M20 | 323.9 | 327.5 | 26 | 26 | 26 | 282 | 46 | 68 | 16 | 342 | 350 | 10 | 7.1 |
| 400 | 505 | 460 | 22 | 16 | M20 | 355.6 | 359.5 | 28 | 26 | 26 | 325 | 53 | 68 | 16 | 390 | 400 | 10 | 7.1 |
| 450 | 565 | 515 | 26 | 16 | M24 | 400.4 | 411.0 | 32 | 26 | 26 | 375 | 57 | 72 | 16 | 440 | 456 | 10 | 7.1 |
| 500 | 615 | 565 | 26 | 20 | M24 | 457.0 | 467.0 | 36 | 28 | 28 | 425 | 63 | 72 | 16 | 488 | 502 | 12 | 7.1 |
| 600 | 670 | 620 | 26 | 20 | M24 | 508.0 | 513.5 | 38 | 28 | 28 | 475 | 67 | 75 | 16 | 540 | 559 | 12 | 7.1 |
| 700 | 780 | 725 | 30 | 20 | M27 | 610.0 | 616.5 | 42 | 28 | 34 | 575 | 75 | 80 | 18 | 640 | 658 | 12 | 7.1 |
| 800 | 895 | 840 | 30 | 24 | M27 | 711.0 | - | 30 | 38 | 38 | 670 | - | 80 | 18 | 746 | - | 12 | 8.0 |
| 900 | 1015 | 950 | 33 | 24 | M30 | 813.0 | - | 32 | 42 | 42 | 770 | - | 90 | 18 | 848 | - | 12 | 8.0 |
| 1000 | 1115 | 1050 | 33 | 28 | M30 | 914.0 | - | 34 | 46 | 46 | 860 | - | 95 | 20 | 948 | - | 12 | 10.0 |
| 1200 | 1230 | 1160 | 36 | 28 | M33 | 1060.0 | - | 34 | 52 | 52 | 960 | - | 95 | 20 | 1050 | - | 12 | 10.0 |
| 1400 | 1455 | 1380 | 39 | 32 | M36 | 1220.0 | - | 38 | 60 | 60 | 1160 | - | 115 | 25 | 1256 | - | 12 | 11.0 |
| 1600 | 1675 | 1590 | 42 | 36 | M39 | 1420.0 | - | 42 | - | - | - | - | 120 | 25 | 1460 | - | 12 | 12.0 |
| 1800 | 1915 | 1820 | 48 | 40 | M45 | 1620.0 | - | 46 | - | - | - | - | 130 | 25 | 1666 | - | 12 | 14.0 |
| 2000 | 2115 | 2020 | 48 | 44 | M45 | 1820.0 | - | 50 | - | - | - | - | 140 | 30 | 1866 | - | 15 | 15.0 |
| 2200 | 2325 | 2230 | 48 | 48 | M45 | 2020.0 | - | 54 | - | - | - | - | 150 | 30 | 2070 | - | 15 | 16.0 |
| 2400 | 2550 | 2440 | 56 | 52 | M52 | 2220.0 | - | 58 | - | - | - | - | 160 | 35 | 2275 | - | 18 | - |
| 2600 | 2760 | 2650 | 56 | 56 | M52 | 2420.0 | - | 62 | - | - | - | - | 170 | 35 | 2478 | - | 18 | - |
| 2800 | 2960 | 2850 | 56 | 60 | M52 | 2620.0 | - | 66 | - | - | - | - | 180 | 40 | 2680 | - | 18 | - |
| 3000 | 3180 | 3070 | 56 | 64 | M52 | 2820.0 | - | 70 | - | - | - | - | 190 | 40 | 2882 | - | 18 | - |
| | 3405 | 3290 | 62 | 68 | M56 | 3020.0 | - | 75 | - | - | - | - | 200 | 45 | 3085 | - | 18 | - |

BS 4504 PN16

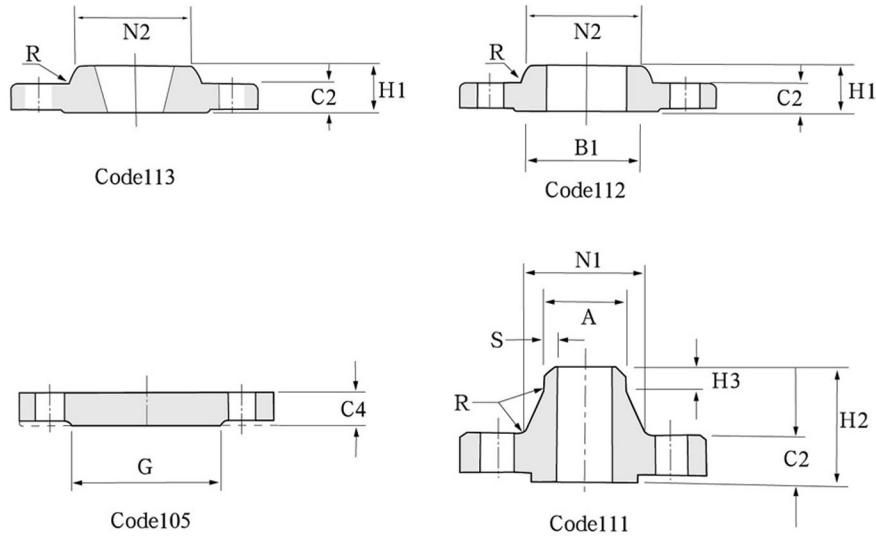

Unit:mm

| Nominal size DN | Mating dimensions | | | | | Outside diameter of neck A | Bore diameters B1 | Flange thickness | | | Diameter of shoulder G | Lengths | | | Neck diameters | | Radius R | Neck thickness S |
|-----------------|--------------------------|---------------------------|-------------------------|--------|------|----------------------------|-------------------|------------------|-------------------|-----|------------------------|------------|------------|-----|----------------|------------|-------------------|------------------|
| | Outside diameter D | Diameter of bolt circle K | Diameter of bolt hole L | Number | Size | | | C1 | C2 | C4 | | H1 | H2 | H3 | N1 | N2 | | |
| Codes affect.ed | 101, 105, 111, 112, 113, | | | | | 111 | 101 102 | 101 | 111 112 113 | 105 | 105 | 112 113 | 111 111 | 111 | 111 | 112 113 | 111 112 113 | 111 |
| 10 | mm 90 | mm 60 | mm 14 | mm 4 | M12 | 17.2 | 18.0 | 14 | 14 | 14 | - | 20 | 35 | 6 | 28 | 30 | 3 | 1.8 |
| 15 | 95 | 65 | 14 | 4 | M12 | 21.3 | 22.0 | 14 | 14 | 14 | - | 20 | 35 | 6 | 32 | 35 | 3 | 2.0 |
| 20 | 105 | 75 | 14 | 4 | M12 | 26.9 | 27.5 | 16 | 16 | 16 | - | 24 | 38 | 6 | 39 | 45 | 4 | 2.3 |
| 25 | 115 | 85 | 14 | 4 | M12 | 33.7 | 34.5 | 16 | 16 | 16 | - | 24 | 38 | 6 | 46 | 52 | 4 | 2.6 |
| 32 | 140 | 100 | 18 | 4 | M16 | 42.4 | 43.5 | 18 | 16 | 16 | - | 26 | 40 | 6 | 56 | 60 | 5 | 2.6 |
| 40 | 150 | 110 | 18 | 4 | M16 | 48.3 | 49.5 | 18 | 16 | 16 | - | 26 | 42 | 7 | 64 | 70 | 5 | 2.6 |
| 50 | 165 | 125 | 18 | 4 | M16 | 60.3 | 61.5 | 20 | 18 | 18 | - | 28 | 45 | 8 | 74 | 84 | 5 | 2.9 |
| 65 | 185 | 145 | 18 | 4 | M16 | 76.1 | 77.5 | 20 | 18 | 18 | 55 | 32 | 45 | 10 | 92 | 104 | 6 | 2.9 |
| 80 | 200 | 160 | 18 | 8 | M16 | 88.9 | 90.5 | 20 | 20 | 20 | 70 | 34 | 50 | 10 | 110 | 118 | 6 | 3.2 |
| 100 | 220 | 180 | 18 | 8 | M16 | 114.3 | 116.5 | 22 | 20 | 20 | 90 | 40 | 52 | 12 | 130 | 140 | 6 | 3.6 |
| 125 | 250 | 210 | 18 | 8 | M16 | 139.7 | 141.5 | 22 | 22 | 22 | 115 | 44 | 55 | 12 | 158 | 168 | 6 | 4.0 |
| 150 | 285 | 240 | 22 | 8 | M20 | 168.3 | 170.5 | 24 | 22 | 22 | 140 | 44 | 55 | 12 | 184 | 195 | 8 | 4.5 |
| 200 | 340 | 295 | 22 | 12 | M20 | 219.1 | 221.5 | 26 | 24 | 24 | 190 | 44 | 62 | 16 | 234 | 248 | 8 | 5.6 |
| 250 | 405 | 355 | 26 | 12 | M24 | 273.0 | 276.5 | 29 | 26 | 26 | 235 | 46 | 70 | 16 | 288 | 298 | 10 | 6.3 |
| 300 | 460 | 410 | 26 | 12 | M24 | 323.9 | 327.5 | 32 | 28 | 28 | 285 | 46 | 78 | 16 | 342 | 350 | 10 | 7.1 |
| 350 | 520 | 470 | 26 | 16 | M24 | 355.6 | 359.0 | 35 | 30 | 30 | 325 | 57 | 82 | 16 | 390 | 400 | 10 | 8.0 |
| 400 | 580 | 525 | 30 | 16 | M27 | 406.4 | 411.0 | 38 | 32 | 32 | 375 | 63 | 85 | 16 | 444 | 456 | 10 | 8.0 |
| 450 | 640 | 585 | 30 | 20 | M27 | 457.0 | 462.0 | 42 | 34 | 36 | 425 | 68 | 87 | 16 | 490 | 502 | 12 | 8.0 |
| 500 | 715 | 650 | 33 | 20 | M30 | 508.0 | 513.0 | 46 | 34 | 36 | 475 | 73 | 90 | 16 | 546 | 559 | 12 | 8.0 |
| 600 | 840 | 770 | 36 | 20 | M33 | 610.0 | 616.5 | 52 | 36 | 44 | 575 | 83 | 95 | 18 | 650 | 658 | 12 | 8.8 |
| 700 | 910 | 840 | 36 | 24 | M33 | 711.0 | - | 60* | 36 | 48 | 670 | 83 | 100 | 18 | 750 | 760 | 12 | 8.8 |
| 800 | 1025 | 950 | 39 | 24 | M36 | 813.0 | - | 68* | 38 | 52 | 770 | 90 | 105 | 20 | 848 | 864 | 12 | 10.0 |
| 900 | 1125 | 1050 | 39 | 28 | M36 | 914.0 | - | 76* | 40 | 58 | 860 | 94 | 110 | 20 | 948 | 968 | 12 | 10.0 |
| 1000 | 1255 | 1170 | 42 | 28 | M39 | 1016.0 | - | 84* | 42 | 64 | 960 | 100 | 120 | 22 | 1056 | 1072 | 12 | 10.0 |
| 1200 | 1485 | 1390 | 48 | 32 | M45 | 1220.0 | - | 98* | 48 | 76 | 1160 | - | 130 | 30 | 1260 | - | 12 | 12.5 |
| 1400 | 1685 | 1820 | 48 | 36 | M45 | 1420.0 | - | - | 52 | - | - | - | 145 | 30 | 1465 | - | 12 | 14.2 |
| 1600 | 1930 | 1820 | 56 | 40 | M52 | 1620.0 | - | - | 58 | - | - | - | 160 | 35 | 1668 | - | 12 | 16.0 |
| 1800 | 2130 | 2020 | 56 | 44 | M52 | 1820.0 | - | - | 62 | - | - | - | 170 | 35 | 1870 | - | 15 | 17.5 |
| 2000 | 2345 | 2230 | 62 | 48 | M56 | 2020.0 | - | - | 66 | - | - | - | 190 | 40 | 2072 | - | 15 | 20.0 |

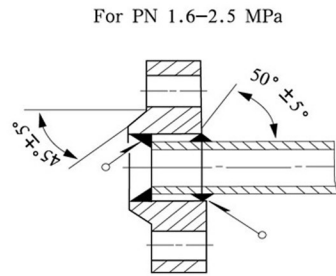
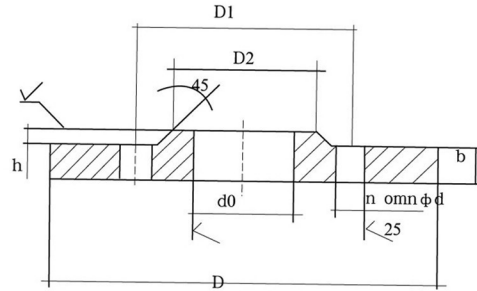
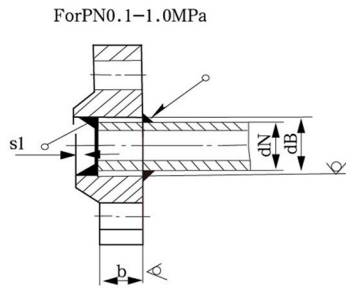

SLIP-ON FLANGES

| OUR REQUIRED DIMENSIONS (ACCORDING GOST) | | | | | | | | | | | | |
|--|-----|-------------------------|--|---------------------------|--|---------------------------------|---------------------------|----------------------------------|-------------------------------|--|---|-------------------|
| PN | DN | Mounting dimension | | | OD (outside diameter of the pipe), mm (dH) | Diameter of the raised face, D2 | Bolts | | Thickness | | | GOST Weight kg/pc |
| | | Ouioide diameter, mm, D | Bolts holes axis diameter (centers of the opposite holes), mm D1 | Inside diameter r, mm (d) | | | Number of bolts' holes, n | Diameter of bolts' holes, mm (d) | flange ridge's height, rmm(h) | Total thickness (together with ridge's height), mm (h+b) | Thickness (without ridge's heighe), mm(b) | |
| 0.6 | 20 | 90 | 65 | 26 | 25 | 50 | 4 | 11 | 2 | 14 | 12 | 0.58 |
| | 25 | 100 | 75 | 33 | 32 | 60 | 4 | 11 | 2 | 14 | 12 | 0.64 |
| | 32 | 120 | 90 | 39 | 38 | 70 | 4 | 14 | 2 | 15 | 13 | 1.01 |
| | 40 | 130 | 100 | 46 | 45 | 80 | 4 | 14 | 3 | 16 | 13 | 1.21 |
| | 50 | 140 | 110 | 59 | 57 | 90 | 4 | 14 | 3 | 16 | 13 | 1.33 |
| | 65 | 160 | 130 | 78 | 76 | 100 | 4 | 14 | 3 | 18 | 15 | 1.63 |
| | 80 | 185 | 150 | 91 | 89 | 128 | 4 | 18 | 3 | 18 | 15 | 2.44 |
| | 100 | 205 | 170 | 110 | 108 | 148 | 4 | 18 | 3 | 18 | 15 | 2.85 |
| | 125 | 235 | 200 | 135 | 133 | 178 | 8 | 18 | 3 | 20 | 17 | 3.88 |
| | 150 | 260 | 225 | 161 | 159 | 202 | 8 | 18 | 3 | 20 | 17 | 4.39 |
| | 200 | 315 | 280 | 222 | 219 | 258 | 8 | 18 | 3 | 22 | 19 | 5.89 |
| | 250 | 370 | 335 | 273 | 273 | 312 | 12 | 18 | 3 | 23 | 20 | 7.67 |
| | 300 | 435 | 395 | 325 | 325 | 365 | 12 | 22 | 4 | 24 | 20 | 10.28 |
| | 350 | 485 | 445 | 377 | 377 | 415 | 12 | 22 | 4 | 26 | 22 | 12.58 |
| | 400 | 535 | 495 | 426 | 426 | 465 | 16 | 22 | 4 | 28 | 24 | 15.2 |
| | 500 | 640 | 600 | 530 | 530 | 270 | 16 | 22 | 4 | 29 | 25 | 19.72 |
| 600 | 755 | 705 | 630 | 630 | 670 | 20 | 26 | 5 | 30 | 25 | 26.24 | |
| 800 | 975 | 920 | 820 | 820 | 880 | 24 | 30 | 5 | 32 | 27 | 46.14 | |

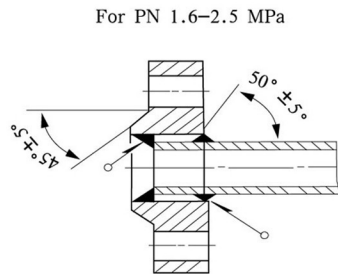
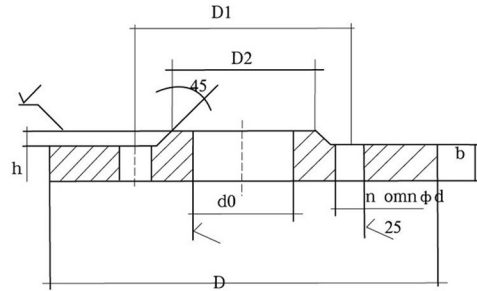
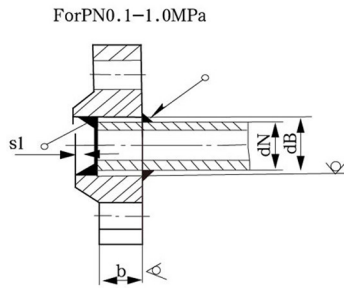

SLIP-ON FLANGES

| OUR REQUIRED DIMENSIONS (ACCORDING GOST) | | | | | | | | | | | | |
|--|------|-------------------------|--|---------------------------|--|---------------------------------|---------------------------|----------------------------------|-------------------------------|--|---|-------------------|
| PN | DN | Mounting dimension | | | OD (outside diameter of the pipe), mm (dH) | Diameter of the raised face, D2 | Bolts | | Thickness | | | GOST Weight kg/pc |
| | | Ouioide diameter, mm, D | Bolts holes axis diameter (centers of the opposite holes), mm D1 | Inside diameter r, mm (d) | | | Number of bolts' holes, n | Diameter of bolts' holes, mm (d) | flange ridge's height, rmm(h) | Total thickness (together with ridge's height), mm (h+b) | Thickness (without ridge's heighe), mm(b) | |
| 1.0 | 10 | 90 | 60 | 15 | 14 | 42 | 4 | 14 | 2 | 12 | 10 | 0.46 |
| | 15 | 95 | 65 | 19 | 18 | 47 | 4 | 14 | 2 | 12 | 10 | 0.51 |
| | 20 | 105 | 75 | 26 | 25 | 58 | 4 | 14 | 2 | 14 | 12 | 0.74 |
| | 25 | 115 | 85 | 33 | 32 | 68 | 4 | 14 | 2 | 14 | 12 | 0.89 |
| | 32 | 135 | 100 | 39 | 38 | 78 | 4 | 18 | 2 | 16 | 14 | 1.4 |
| | 40 | 145 | 110 | 46 | 45 | 88 | 4 | 18 | 3 | 18 | 15 | 1.71 |
| | 50 | 160 | 125 | 59 | 57 | 102 | 4 | 18 | 3 | 18 | 15 | 2.06 |
| | 65 | 180 | 145 | 78 | 76 | 122 | 4 | 18 | 3 | 20 | 17 | 2.8 |
| | 80 | 195 | 160 | 91 | 89 | 133 | 4 | 18 | 3 | 20 | 17 | 3.19 |
| | 100 | 215 | 180 | 110 | 108 | 158 | 8 | 18 | 3 | 22 | 19 | 3.96 |
| | 125 | 245 | 210 | 135 | 133 | 184 | 8 | 18 | 3 | 24 | 21 | 5.15 |
| | 150 | 280 | 240 | 161 | 159 | 212 | 8 | 22 | 3 | 24 | 21 | 6.62 |
| | 200 | 335 | 295 | 222 | 219 | 268 | 8 | 22 | 3 | 24 | 21 | 8.05 |
| | 250 | 390 | 350 | 273 | 273 | 320 | 12 | 22 | 3 | 26 | 23 | 10.65 |
| | 300 | 440 | 400 | 325 | 325 | 370 | 12 | 22 | 4 | 28 | 24 | 12.9 |
| | 350 | 500 | 460 | 377 | 377 | 430 | 16 | 22 | 4 | 28 | 24 | 15.85 |
| | 400 | 565 | 515 | 426 | 426 | 482 | 16 | 26 | 4 | 30 | 26 | 21.56 |
| | 500 | 670 | 620 | 530 | 530 | 585 | 20 | 26 | 4 | 32 | 28 | 27.7 |
| 600 | 780 | 725 | 630 | 630 | 685 | 20 | 30 | 5 | 36 | 31 | 39.4 | |
| 800 | 1010 | 950 | 820 | 820 | 905 | 24 | 33 | 5 | 42 | 37 | 79.16 | |
| 1000 | 1220 | 1160 | 1020 | 1020 | 1110 | 28 | 33 | 5 | 48 | 43 | 118.43 | |
| 1200 | 1455 | 1380 | 1222 | 1222 | 1330 | 32 | 39 | 5 | 56 | 51 | 197.44 | |
| 1400 | 1675 | 1590 | 1420 | 1420 | 1530 | 36 | 45 | 5 | 65 | 60 | 278.92 | |
| 1600 | 1915 | 1820 | 1620 | 1620 | 1750 | 40 | 52 | 5 | 75 | 70 | 422.65 | |

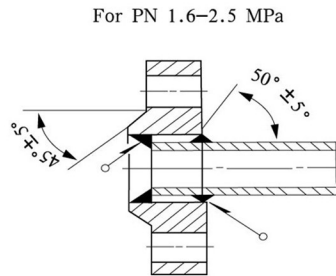
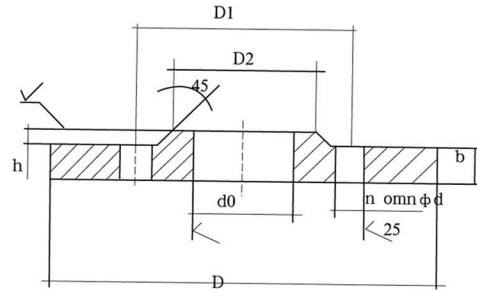
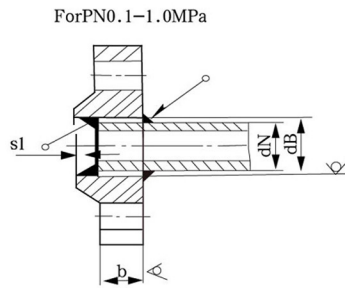

SLIP-ON FLANGES

| OUR REQUIRED DIMENSIONS (ACCORDING GOST) | | | | | | | | | | | | |
|--|------|-------------------------|--|---------------------------|--|---------------------------------|---------------------------|----------------------------------|------------------------------|--|---|-------------------|
| PN | DN | Mounting dimension | | | OD (outside diameter of the pipe), mm (dH) | Diameter of the raised face, D2 | Bolts | | Thickness | | | GOST Weight kg/pc |
| | | Outside diameter, mm, D | Bolts holes axis diameter (centers of the opposite holes), mm D1 | Inside diameter r, mm (d) | | | Number of bolts' holes, n | Diameter of bolts' holes, mm (d) | flange ridge's height, mm(h) | Total thickness (together with ridge's height), mm (h+b) | Thickness (without ridge's height), mm(b) | |
| 1.6 | 10 | 90 | 60 | 15 | 14 | 42 | 4 | 14 | 2 | 14 | 12 | 0.54 |
| | 15 | 95 | 65 | 19 | 18 | 47 | 4 | 14 | 2 | 14 | 12 | 0.61 |
| | 20 | 105 | 75 | 26 | 25 | 58 | 4 | 14 | 2 | 16 | 14 | 0.86 |
| | 25 | 115 | 85 | 33 | 32 | 68 | 4 | 14 | 2 | 16 | 14 | 1.17 |
| | 32 | 135 | 100 | 39 | 38 | 78 | 4 | 18 | 2 | 18 | 16 | 1.58 |
| | 40 | 145 | 110 | 46 | 45 | 88 | 4 | 18 | 3 | 20 | 17 | 1.96 |
| | 50 | 160 | 125 | 59 | 57 | 102 | 4 | 18 | 3 | 22 | 19 | 2.58 |
| | 65 | 180 | 145 | 78 | 76 | 122 | 4 | 18 | 3 | 24 | 21 | 3.42 |
| | 80 | 195 | 160 | 91 | 89 | 133 | 4 | 18 | 3 | 24 | 21 | 3.71 |
| | 100 | 215 | 180 | 110 | 108 | 158 | 8 | 18 | 3 | 26 | 23 | 4.55 |
| | 125 | 245 | 210 | 135 | 133 | 184 | 8 | 18 | 3 | 28 | 25 | 6.38 |
| | 150 | 280 | 240 | 161 | 159 | 212 | 8 | 22 | 3 | 28 | 25 | 7.81 |
| | 200 | 335 | 295 | 222 | 219 | 268 | 12 | 22 | 3 | 30 | 27 | 10.1 |
| | 250 | 405 | 355 | 273 | 273 | 320 | 12 | 26 | 3 | 31 | 28 | 14.49 |
| | 300 | 460 | 410 | 325 | 325 | 370 | 12 | 26 | 4 | 32 | 28 | 17.78 |
| | 350 | 520 | 470 | 377 | 377 | 430 | 16 | 26 | 4 | 34 | 30 | 22.88 |
| | 400 | 580 | 525 | 426 | 426 | 482 | 16 | 30 | 4 | 38 | 34 | 31 |
| 500 | 710 | 650 | 530 | 530 | 585 | 20 | 33 | 4 | 48 | 44 | 57.01 | |
| 600 | 840 | 770 | 630 | 630 | 685 | 20 | 39 | 5 | 50 | 45 | 80.03 | |
| 800 | 1020 | 950 | 820 | 820 | 905 | 24 | 39 | 5 | 54 | 49 | 104.41 | |
| 1000 | 1255 | 1170 | 1020 | 1020 | 1110 | 28 | 45 | 5 | 63 | 58 | 179.37 | |
| 1200 | 1485 | 1390 | 1220 | 1220 | 1330 | 32 | 52 | 5 | 76 | 71 | 297.78 | |

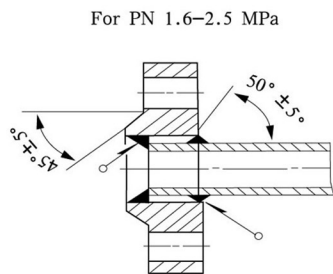
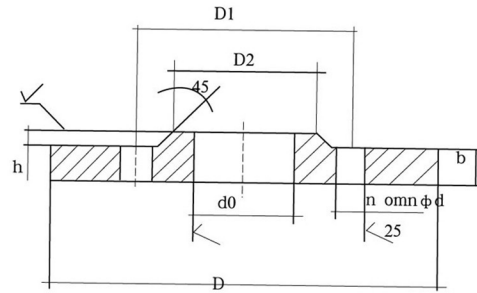
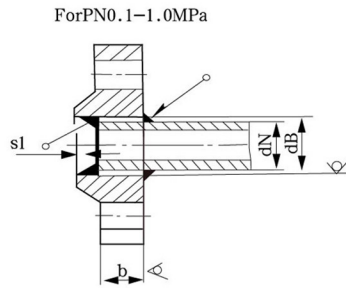

SLIP-ON FLANGES

| OUR REQUIRED DIMENSIONS (ACCORDING GOST) | | | | | | | | | | | | |
|--|------|-------------------------|--|---------------------------|--|---------------------------------|---------------------------|----------------------------------|-------------------------------|--|---|-------------------|
| PN | DN | Mounting dimension | | | OD (outside diameter of the pipe), mm (dH) | Diameter of the raised face, D2 | Bolts | | Thickness | | | GOST Weight kg/pc |
| | | Ouioide diameter, mm, D | Bolts holes axis diameter (centers of the opposite holes), mm D1 | Inside diameter r, mm (d) | | | Number of bolts' holes, n | Diameter of bolts' holes, mm (d) | flange ridge's height, rmm(h) | Total thickness (together with ridge's height), mm (h+b) | Thickness (without ridge's heighe), mm(b) | |
| 2.5 | 10 | 90 | 60 | 15 | 14 | 42 | 4 | 14 | 2 | 16 | 14 | 0.63 |
| | 15 | 95 | 65 | 19 | 18 | 47 | 4 | 14 | 2 | 16 | 14 | 0.7 |
| | 20 | 105 | 75 | 26 | 25 | 58 | 4 | 14 | 2 | 18 | 16 | 0.98 |
| | 25 | 115 | 85 | 33 | 32 | 68 | 4 | 14 | 2 | 18 | 16 | 1.17 |
| | 32 | 135 | 100 | 29 | 38 | 78 | 4 | 18 | 2 | 20 | 18 | 1.77 |
| | 40 | 145 | 110 | 46 | 45 | 88 | 4 | 18 | 3 | 22 | 19 | 2.58 |
| | 50 | 160 | 125 | 59 | 57 | 102 | 4 | 18 | 3 | 24 | 21 | 2.71 |
| | 65 | 180 | 145 | 78 | 76 | 122 | 8 | 18 | 3 | 24 | 21 | 3.22 |
| | 80 | 195 | 160 | 91 | 89 | 133 | 8 | 18 | 3 | 26 | 23 | 4.06 |
| | 100 | 230 | 190 | 110 | 108 | 158 | 8 | 22 | 3 | 28 | 25 | 5.92 |
| | 125 | 270 | 220 | 135 | 133 | 184 | 8 | 26 | 3 | 30 | 27 | 8.26 |
| | 150 | 300 | 250 | 161 | 159 | 212 | 8 | 26 | 3 | 30 | 27 | 10.12 |
| | 200 | 360 | 310 | 222 | 219 | 278 | 12 | 26 | 3 | 32 | 29 | 13.34 |
| | 250 | 425 | 370 | 273 | 273 | 335 | 12 | 30 | 3 | 34 | 31 | 18.9 |
| | 300 | 485 | 430 | 325 | 325 | 390 | 16 | 30 | 4 | 36 | 32 | 23.95 |
| | 350 | 550 | 490 | 377 | 377 | 450 | 16 | 33 | 4 | 42 | 38 | 34.35 |
| 400 | 610 | 550 | 426 | 426 | 505 | 16 | 33 | 4 | 44 | 40 | 44.62 | |
| 500 | 730 | 660 | 530 | 530 | 615 | 20 | 39 | 4 | 52 | 48 | 67.3 | |
| 600 | 840 | 770 | 630 | 630 | 720 | 20 | 39 | 5 | 54 | 49 | 90.87 | |
| 800 | 1075 | 990 | 820 | 820 | 930 | 24 | 45 | 5 | 68 | 63 | 181.43 | |